



Transit-Oriented Redevelopment in New Orleans?

Posted by [Super G](#) on January 12, 2006 - 11:17am

Topic: [Environment/Sustainability](#)

Tags: [hurricane katrina](#), [new orleans](#), [new urbanism](#), [transit-oriented development](#) [[list all tags](#)]

New Orleans Mayor Ray Nagin's [Bring New Orleans Back Commission](#) has released a master plan for the rebuilding of the city ([Powerpoint](#), [PDF courtesy of NPR](#)). Most of the news coverage of the plan focuses on the controversial process that determines which neighborhoods will be rebuilt. But the plan also embraces transit-oriented development and other new urbanist concepts.

I've excerpted some of the key slides and figures below the fold. Do their ideas have merit? Will they ever get implemented?

Transit and Transportation Action Plan

- City-wide, high speed, light rail transit network connects neighborhoods to downtown and other employment centers.
- Light rail transit creates value and is a catalyst for reconstruction and new development.
- Rail transit links city to the airport, Baton Rouge, and the Gulf Coast.
- New roads will be designed with the wide median (neutral ground) model for pedestrians, bicycles, transit, and open space.

Immediate:

- Repair existing streetcar lines and rolling stock; restore bus service.
- Update plan for transit based on new circumstances.
- Design light rail lines plus rapid transit to the airport, Baton Rouge and the region.
- Secure funding for the rail system.
- Repair and improve streets and associated drainage.

Longer-term:

- Construct connections, jointly with the states of Louisiana and Mississippi, to the airport/Baton Rouge, Slidell, and the Gulf Coast.
- Construct new light rail lines.
- Develop bus rapid transit routes to improve service and connect to high speed, light rail lines.
- As population increases, convert highest use bus rapid transit to fixed rail.



Bring New Orleans Back Commission Transit and Transportation Action Plan.

Neighborhood Center Model

- Neighborhoods are the centers of activity and daily life.
- Neighborhoods require sufficient population to support the equitable and efficient provision of public facilities and services.
- Every neighborhood must have:
 - Basic infrastructure: roads, drainage, utilities, services
 - Public schools
 - Cultural and community facilities
 - Places of worship
 - Health facilities
 - Park and open space within an easy walk
 - Convenience retail
 - Access to public transit

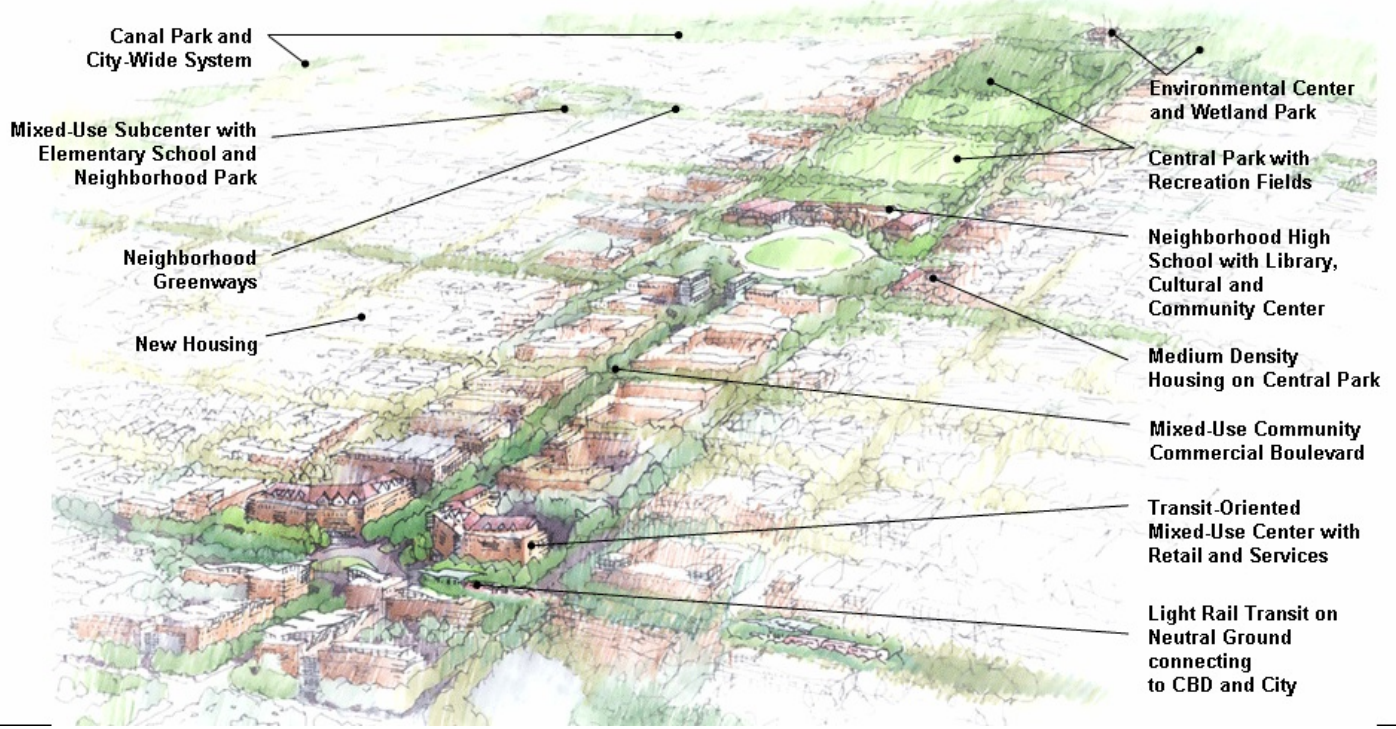

Bring New Orleans Back Commission Neighborhood Center Model.



This work is licensed under a [Creative Commons Attribution-Share Alike 3.0 United States License](https://creativecommons.org/licenses/by-sa/3.0/).